



**GOS MARINE ENGINEERING
INTERNATIONAL LIMITED
金舵輪船舶工程國際有限公司**

Hong Kong, China



GOS Marine Engineering International Limited (GMEC), headquartered in the bustling maritime hub of Hong Kong SAR, China, operates as a premier ship broker and agent. The company has carved out a niche in the highly competitive marine industry by specializing in the sales of a diverse range of vessel types through strategic partnerships with some of the most prestigious shipyards across China.

GMEC focuses on high-performance, multipurpose vessels tailored to the stringent demands of modern maritime operations. Among its standout offerings are advanced high-speed assault landing crafts, designed for swift deployment in military contexts, and high-speed interceptor boats, vital for security and law enforcement missions. GMEC also markets law enforcement vessels and patrol boats, which are essential for maintaining safety and order in maritime territories. Additionally, the company's innovative portfolio includes new heavy-duty ribbon pontoon bridges, the new type bridge erection auto boats, and new type emergency pavements. These specialized units are designed to support and enhance infrastructure capabilities in both routine and emergency marine operations.

Over the years, GMEC has solidified its reputation by successfully delivering over hundred vessels and boats worldwide. Their extensive portfolio not only includes specialized military and law enforcement boats but also spans to commercial and industrial vessels such as chemical vessels, oil tankers, dry cargo vessels, and a variety of fishing vessels like tuna longline and shrimp boats. The company's capability extends further to include complex engineering boats, dredgers, and customized passenger boats, showcasing their versatility and comprehensive expertise in the shipbuilding sector.

GMEC's vision and mission are rooted in the delivery of unparalleled quality in vessel production and aspiring to become the most competitive and comprehensive entity in the global marine engineering market. The company is committed to fostering innovative designs and sustainable practices in its operations to promote mutual benefits and pave the way for a prosperous future. Through dedication to excellence and a strategy focused on diversified development, GMEC continues to push the boundaries of what is possible in the marine engineering sphere.



Depended on research, and development, ship design, as well as service of ship technology with a number of the dedicated engineers who excel in modern design methods, and 3D modeling technology with powerful Finite Element Analysis (FEA). The digital production design provides a strong support for digital construction.

➤ “Load-Fit” Scantling and Erection Simulation

A Dedicated Team with Powerful Structural Analysis Capability.

➤ Digital Construction

Digital technology based construction simulation has been widely applied for construction plan, block erection, mega block lifting and production schedule calibration.

➤ Digital Welding Quality Control System

Digital Welding Quality Control system (DWQC) transforms the conventional welding quality control pattern to a systematized engineering base on cyber system and data base technology. DWQC can hugely improve the welding quality and enhance the production efficiency as well.

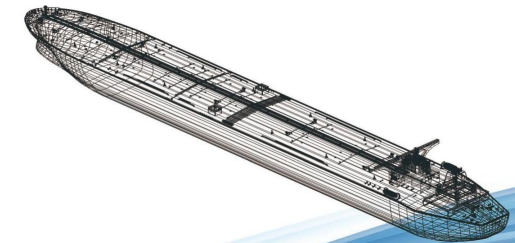
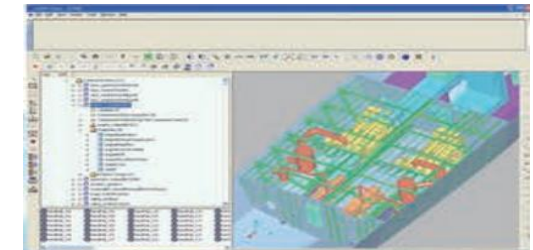
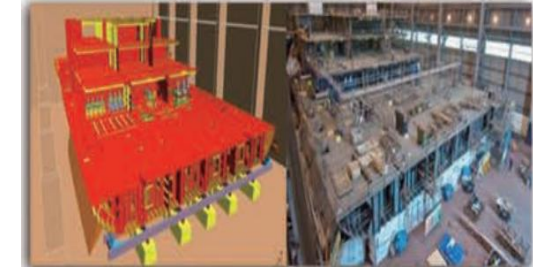



产品简介 Brief introduction

新型带式重型舟桥一个连套装备包括15只河中舟、2只岸边舟、5艘架桥汽艇、22辆运载车及附属设备。可架设60吨单行道浮桥126米，或结构载重量60吨的漕渡门桥5个。整车满足公路机动要求；分装后满足铁路运输要求。

One set of new type heavy-duty pontoon bridge is formed by fifteen (15) river boats, two (2) shore boats, 5 bridge erection auto boats, twenty two (22) carrier vehicles and correspondent ancillary equipment, which can erect 126m single lane floating bridge of 60T, or 5 ferry gate bridges of 60T structural loading capacity. The whole set can meet mobility requirements of road transportation, and meet the railway transportation requirements when separated.

用途 Purpose

新型带式重型舟桥由含河中舟、岸边舟、架桥汽艇、运载车、信息化设备、附属设备等组成。其中，河中舟是浮桥或漕渡门桥的主体承载部分；岸边舟是浮桥的连岸部分或漕渡门桥的靠岸部分；新型架桥汽艇可为门桥、浮桥提供水上动力；运载车用于舟的折叠、舟（艇）的装卸和运输，并为装卸作业机构提供动力和安装布置平台；舟车、艇车完全通用，并可装运通用托盘，还可以装运GZQ230型重型舟桥和GQP130型架桥汽艇。

New type heavy-duty pontoon bridge is composed of river boats, shore boats, bridge erection auto boats, carrier vehicles, information devices and ancillary equipment, etc. Among which, river boat is the main bearing part of floating bridge and ferrying gate bridge; shore boat is the shore connection part of floating or ferry portable bridge; new type bridge erection auto boat can supply aquatic power for the bridges; carrier vehicle used for the boats' stacking and transportation, loading & unloading of the boats(auto boats), also function as power unit and layout platform of loading & unloading operations. Carrier vehicle can carry both boats and auto boats, also can load and transport general trays, as well as model GZQ230 heavy duty pontoon bridge and model GZQ130 bridge erection auto boat.

产品性能及主要参数 Product performance and main index

总体性能 General performance

外形尺寸 (运输状态) Dimensions(transportation)	不大于12.8米 × 3.35米 × 4.0米 > 12.8m*3.35m*4.0m
整备质量Weight	不大于30吨Weight > 30T
最高行驶速度Max driving speed	不小于90千米/小时 < 90km/h
装载、卸载作业时间Loading/unloading time	不大于5分钟 > 5 min
装载、卸载河岸适应性Loading/unloading adaptability	斜坡最大坡度Max gradient of slope 不小于10度 < 10° 陡岸最大岸高Max height of bold shore 不小于1米 < 1m

门桥性能 Basic performance

承载能力Bearing capacity	不小于60吨 < 60T
满载航速Speed (full load)	不小于11千米/小时 < 11km/h
结合作业时间Combination time	不大于10分钟 > 10 min

浮桥性能 Performance of bridge

承载能力Bearing capacity	履带载LD-60、轮式载LT-60 (最大轴压力14吨) Crawler load LD-60, wheel load LT-60 (maximum axle pressure 14T)
车行部宽度 Width of driving path	重型荷载 (单行道) 不小于4.0米 Heavy duty load (single lane) < 4m 轻型车辆 (双行道) 不小于6.5米 Light vehicle (double lanes) < 6.5m
适应最大流速Max suitable flow rate	不小于3.0米/秒 < 3.0m/s
适应最大水深Max suitable depth	不小于15米 < 15m
连套装备单行道浮桥作业时间 Floating bridge operation time of the whole equipment	不大于30分钟 > 30min



河中舟 Pontoon craft



岸边舟 Ferry boat



产品简介 Brief introduction

汽艇由全铝合金艇体、舾装设备、动力推进装置、液压电气及操控系统等部分组成。汽艇的陆上机动由搭载的运载车完成。

运载车是河中舟、岸边舟、架桥汽艇陆上运输装置，并能借助运载车自身的装卸机构，可以完成目前现役的各型带式舟桥河中舟、岸边舟以及架桥汽艇的陆上装卸载和水上泛水作业；也可适用于后勤保障通用托盘的装卸载作业，通用化程度极高，达到国内领先水平。

The auto is composed of aluminum alloy hull, outfitting equipment, power propulsion device, hydraulic and electrical system, control and other system. The land maneuver of the auto boat is completed by the carrier vehicle.

The carrier vehicle is land transportation device for river boat, shore boat and bridge erection auto boat. By means of the loading and unloading mechanism of the carrier itself, it can implement the land loading and unloading and water skimming operations of all types of current servicing ribbon type pontoon bridges (includes river boats, shore boats and bridge erection auto boats); It can also be used for loading and unloading of general pallets for logistics support, with high generalization, reaches the leading level in China.

用途 Purpose

新型架桥汽艇是一种马力大、速度快，机动灵活性较好的水上动力装备。主要用于顶推、牵引和旁带门桥，可以适应3m/s的大流速下架设浮桥等渡河工程作业；亦可执行水上指挥、巡逻、救护、运输等其他水上任务。主要性能指标达到国际先进水平。

The new type bridge erection auto boat is a kind of powerful water power equipment with high speed and good maneuverability. It is mainly used for pushing, towing and side towing ferry gate bridge, which can adapt to the river crossing engineering operations such as erecting floating bridge and so on under the high velocity of 3m / S; it can also perform other water tasks such as water command, patrol, rescue, transportation, etc. The main performance indexes have reached the international advanced level.

产品性能及主要参数 Product performance and main index

总体性能 General performance	
底盘车型号 Chassis model	陕汽SX2306型 (8×8) Shan Xi Auto SX2306(8*8)
整备质量 (汽艇) Weight (auto boat)	不大于28.5吨 >28.5T
乘员数 Passengers	4人 (含驾驶员) 4P (including driver)
陆上最高行驶速度 Max speed on land	不小于120千米/小时 <120km/h
公路最大续航里程 Max road endurance	不小于860千米 <860km
装卸载作业时间 Max unloading time	不大于5分钟 >5min
架桥汽艇性能 Auto boat performance	
最大牵引力 Max towing force	前进: 不小于50千牛 Forward: <50KN
	后退: 不小于25千牛 Backward: <25KN
最大自由航速 Max free speed	不小于45千米/小时 <45km/h
最大续航时间 Max endurance time	不小于6小时 <6h
汽艇作业手 Auto boat operator	2人 (含驾驶员) 2P (including driver)
舟桥结合方式 Combination method	顶推、牵引、旁带或侧推 Pushing/towing/side towing or side pushing





产品简介 Brief introduction

该装备主要由路面系统、作业车、信息化设备及附属器材等组成。整套装备包括80m长机械化作业的铝合金路面和10m长人工拼装六角板铝合金路面。

The pavement is mainly composed of pavement system, operation vehicle, information equipment and ancillary fittings, etc. The whole set includes 80m of mechanical operation aluminum alloy pavement and 10m of Manual assembly hexagonal aluminum alloy pavement.



用途 Purpose

本装备主要用于伴随部队机动、保障武器装备快速克服江河岸浅滩、水际滩头、松软泥泞路段等障碍；也可用于市政工程建设、油田临时道路等。本装备技术性能国内领先。

该装备主要遂行以下作战任务：1) 用于道路工程保障。伴随部队机动，快速构筑行车通道，保障武器装备顺利通过松软泥泞地段；2) 用于渡河工程保障。快速构筑渡场进出路，有效完成浮桥、门桥与机动道路间的衔接，保障武器装备快速渡河。

This pavement is mainly used to assist the troop maneuver, support weapons and equipment to quickly overcome the river bank shoal, water beach, soft muddy road and other obstacles; it can also be used for municipal engineering construction, oilfield temporary roads and so on. The technical performance of this equipment is the lead in China.

The pavement is mainly used to implement the following combat mission: 1) to ensure road engineering, assist troop maneuver, construct traffic passage rapidly, safeguard weapons and equipment to pass soft and muddy area smoothly; 2) to guarantee river crossing engineering, build river crossing vehicle access way fleetly, connect floating bridge, gate bridge and motorway effectively, and safeguard weapon & equipment cross river quickly.

产品性能及主要参数 Product performance and main index

总体性能 General performance	
底盘车型号 Chassis model	SX2300 (8 × 8)
战斗全重 Total weight	不大于30吨 >30T
作业人数 Operator	3人 (含驾驶员) 3P (including driver)
最高行驶速度 Max. driving speed	不小于90千米/小时 <90km/h
作业时间 Operation time	铺设时间：不大于10分钟 Laying time : >10min 撤收时间：不大于20分钟 withdraw time : >20min
路面性能 Pavement performance	
路面段长度 Length of pavement	不小于80米 <80m
路面宽度 Width of pavement	不小于4.2米 <4.2m
适应地基承载力 Adaptive bearing capacity of foundation	不小于70千帕 <70Kpa
作业方式 Operation method	机械化作业为主，人工作业为辅 Essentially mechanical, supplemented with manual operation
承载能力 Bearing capacity	履带载全重：不小于60吨 Crawler bearing capacity : <60T 轮式轴压力：不小于13吨 Wheel shaft pressure : <13T





Main scale, performance parameters and typical equipment		
Length Overall	12.00	m
Moulded Breadth	2.80	m
Moulded Depth	1.40	m
Draft	0.700	m
Crew	10	p
Max. Speed	~ 60	kn
Endurance	~ 200	nm
Sailing Area	Coastal Waters	
Main Engine	Honda BF350 Outboard 3×350	hp
Model	Deep V Multi-Break Class Vessels	
Material	Aluminum	

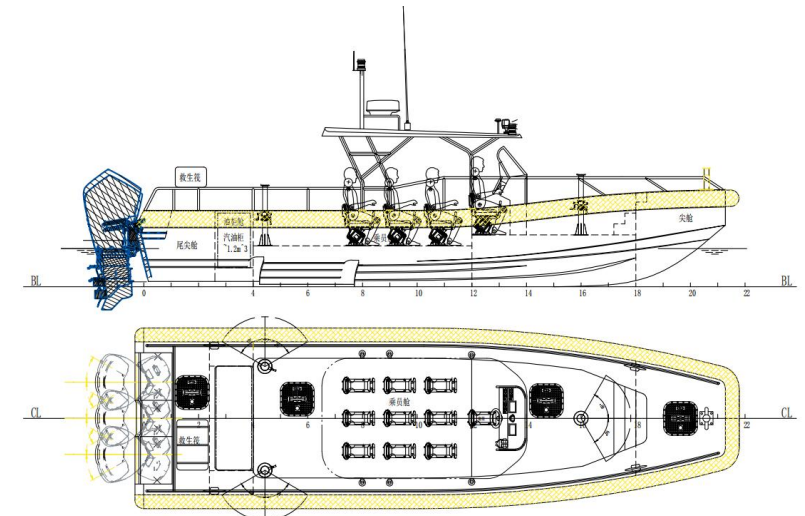



Main scale, performance parameters and typical equipment		
Length Overall	16.841	m
Moulded Breadth	4.541	m
Moulded Depth	2.690	m
Draft	0.900	m
Crew	32~36	p
Max. Speed	~44.6	kn
Endurance	~363	nm
Sailing Area	Coastal Waters	
Main Engine	WP13FY1000-23E201/2×735	kw
Gearboxes/Generator	HCAM403/BTZ-3200X2	
Model	Deep V break class slot transom skiffs	
Material	Aluminum	

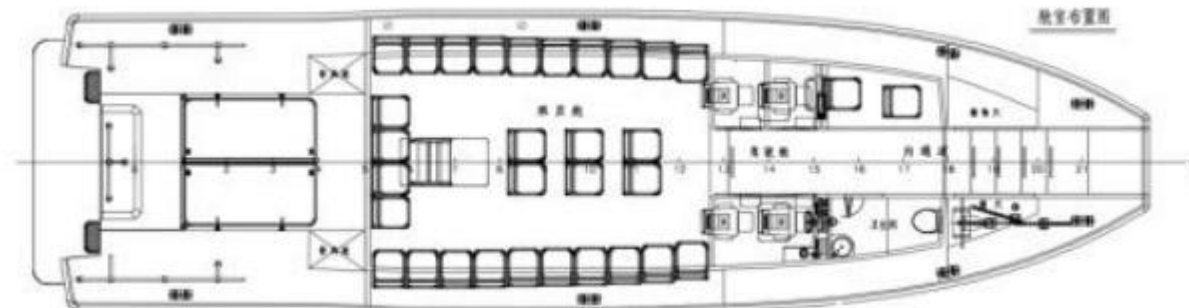



Main scale, performance parameters and typical equipment		
Length Overall	17.428	m
Moulded Breadth	16.779	m
Moulded Depth	4.534	m
Draft	2.564	m
Crew	0.888	m
Max. Speed	32 ~ 36	p
Endurance	~ 44.6	kn
Sailing Area	~ 365	nm
Main Engine	Coastal Waters	
Gearboxes/Generator	WP13FY1000-23E201/2×735	kw
Model	HCAM403/BTZ-3200X2	
Material	Deep V break class slot transom skiffs	

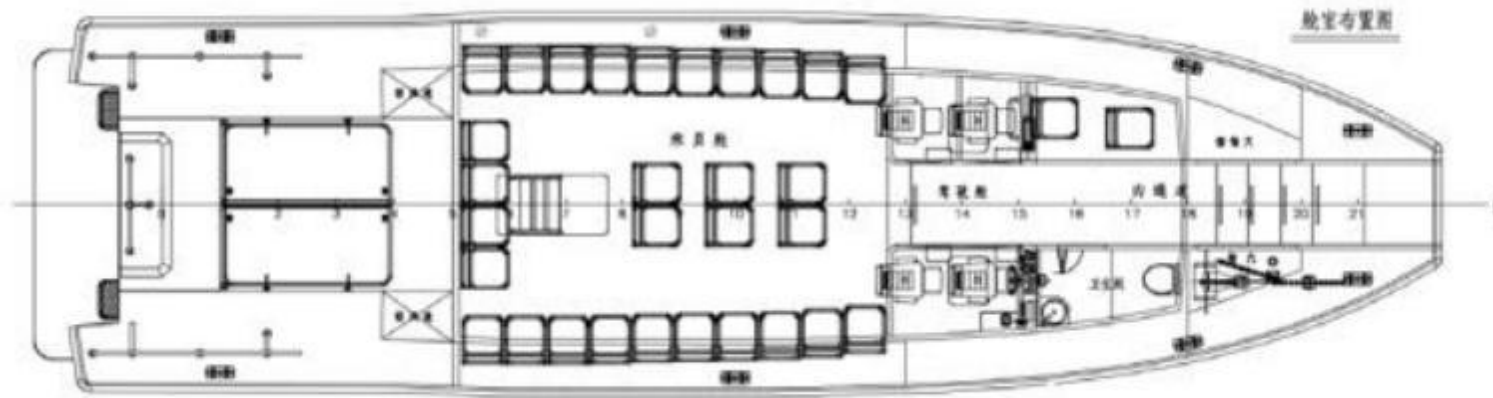



Main scale, performance parameters and typical equipment		
Length Overall	15.118	m
Moulded Breadth	3.980	m
Moulded Depth	2.250	m
Draft	0.838	m
Crew	13 ~ 16	p
Max. Speed	~ 50	k n
Endurance	~ 260	n m
Sailing Area	Coastal Waters	
Main Engine	SCANIA DI13 076M /2 × 607	kw
Gearboxes/Generator	MGX5114A/ASD11 ×2	
Model	Deep V breakaway skiff	
Material	Aluminum/Fiberglass	

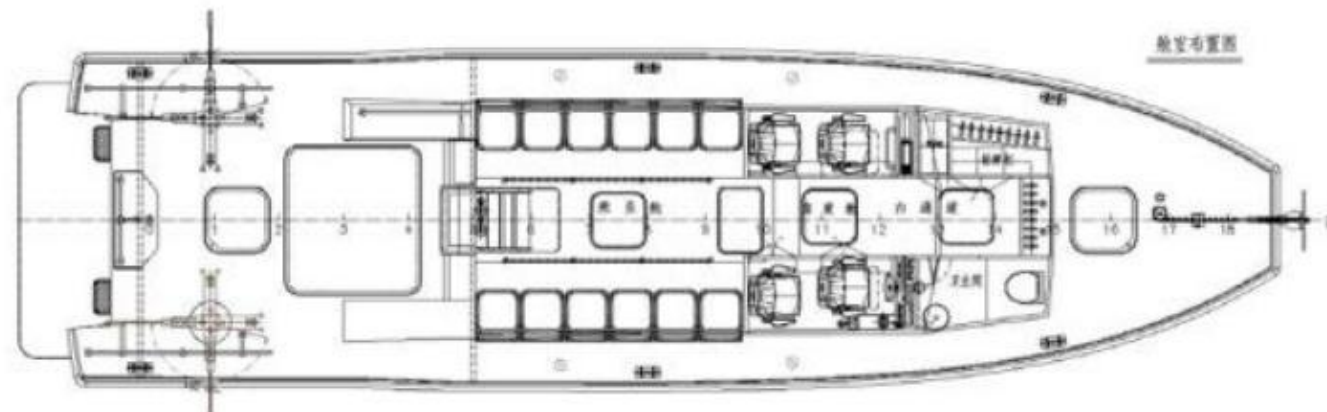



Main scale, performance parameters and typical equipment		
Length Overall	27.104	m
Moulded Breadth	7.039	m
Moulded Depth	3.481	m
Draft	1.188	m
Crew	8 ~ 16	p
Max. Speed	~ 45	k n
Endurance	~ 400	n m
Sailing Area	Coastal Waters	
Main Engine	MTU16V2000M94/2×1939	kw
Gearboxes/Generator	ZF5050A/ASD16	
Model	Deep V break class slot transom skiffs	
Material	Aluminum/Fiberglass	

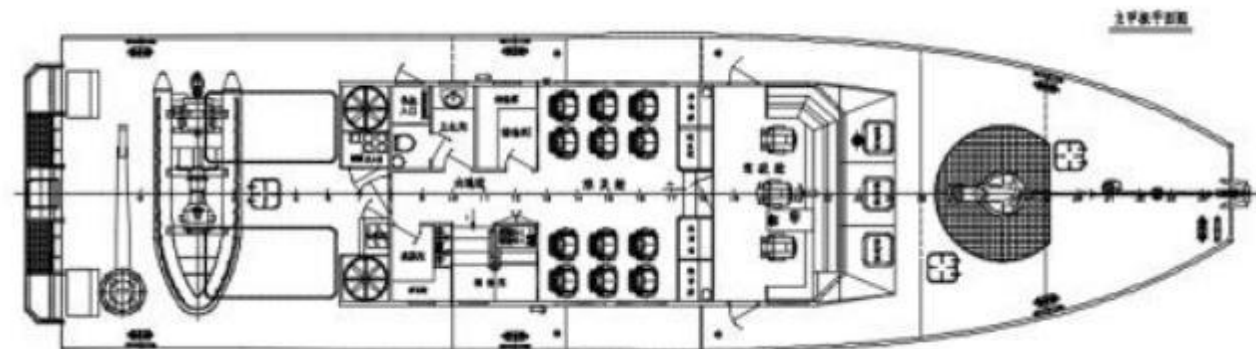



Main scale, performance parameters and typical equipment		
Length Overall	14.892	m
Moulded Breadth	3.720	m
Moulded Depth	1.953	m
Draft	0.780	m
Crew	8	p
Max. Speed	≥ 55	k n
Endurance	~ 222	n m
Sailing Area	Coastal Waters	
Main Engine	D 13-800 / 2X 588	k w
Gearboxes/Generator	MG5114A/ASD10	
Model	Deep V Multi-Break Class Vessels	
Material	Aluminum/Fiberglass	

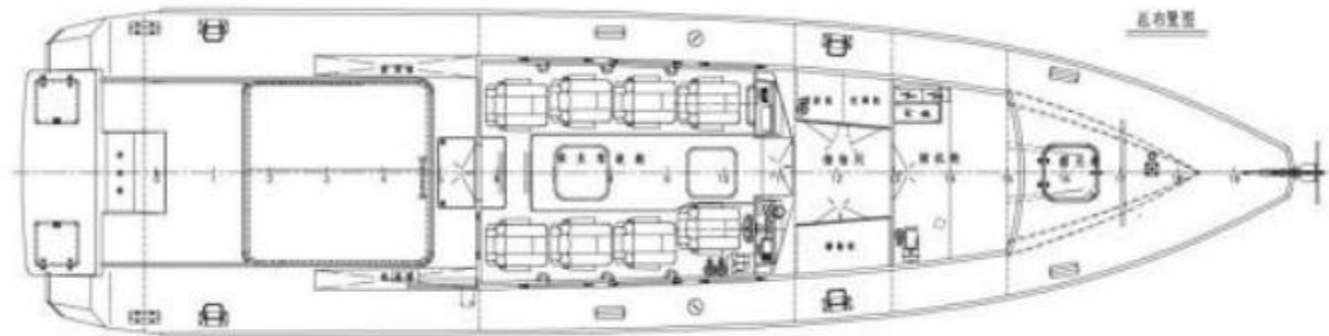



Main scale, performance parameters and typical equipment		
Length Overall	20.404	m
Moulded Breadth	5.187	m
Moulded Depth	2.589	m
Draft	0.971	m
Crew	10	p
Max. Speed	~ 56.3	kn
Endurance	~ 304	nm
Sailing Area	Coastal Waters	
Main Engine	MTU10V2000M96/2 X1120	kw
Gearboxes/Generator	ZF3000/SDS5	
Model	Deep V Multi-Break Class Vessels	
Material	Aluminum/Fiberglass	

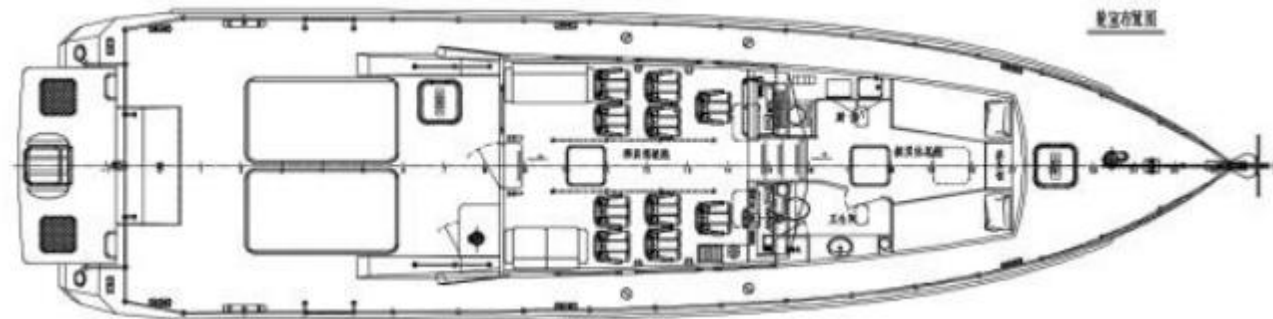



Main scale, performance parameters and typical equipment		
Length Overall	22.30	m
Moulded Breadth	5.80	m
Moulded Depth	2.70	m
Draft	1.25	m
Crew	8	p
Max. Speed	~ 30	kn
Endurance	~ 500	n m
Sailing Area	Coastal Waters	
Main Engine	MTU10V2000M96/2 X1120	kw
Gearboxes/Generator	ZF3000/SDS5	
Model	Deep V Multi-Break Class Vessels	
Material	Aluminum	

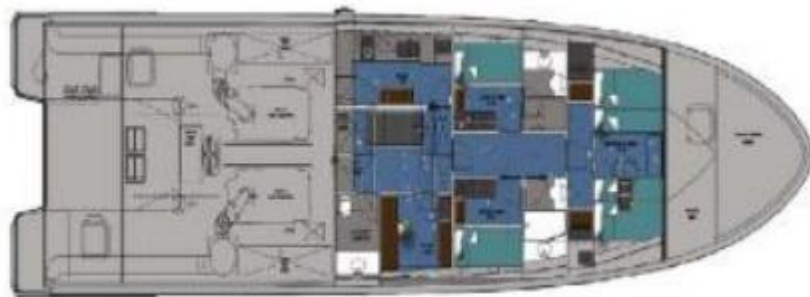

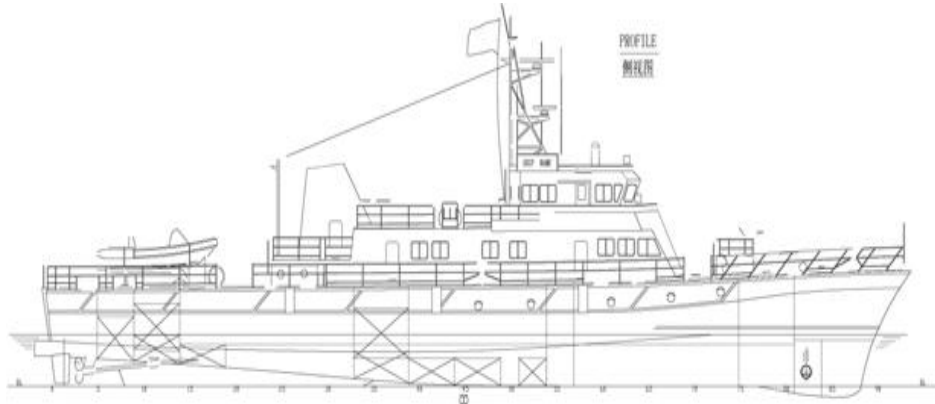

PROFILE
側視圖

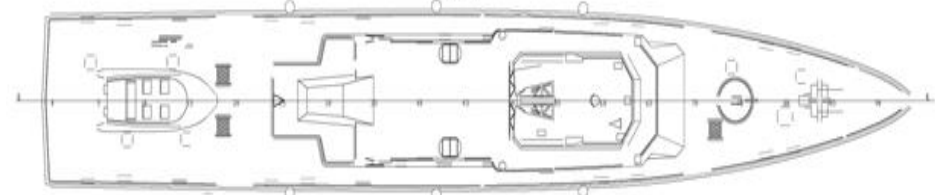

BIRD'S VIEW
俯視圖

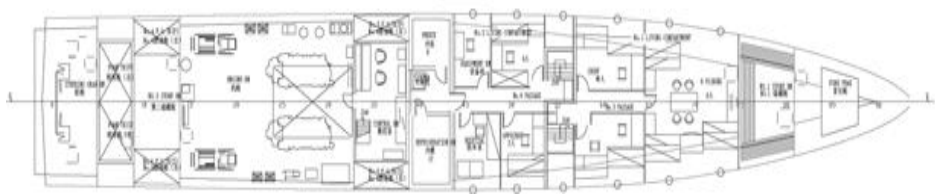

BELOW MAIN DECK
上甲板下

Main scale, performance parameters and typical equipment		
Length Overall	36.00	m
Moulded Breadth	7.60	m
Moulded Depth	3.30	m
Draft	1.70	m
Crew	10	p
Max. Speed	~ 23	k n
Endurance	~ 1200	n m
Sailing Area	Coastal Waters	
Main Engine	M C R / 3 X 1350	k w
Gearboxes/Generator	ZF3000/SDS5	
Model	Deep V Multi-Break Class Vessels	
Material	Aluminum	





*In order to strength the Sale performance as the center.
In order to improve the level of management as the foundation.
By providing a full range of services of selling and building vessels and boats, become an
international comprehensive reputable seller.*

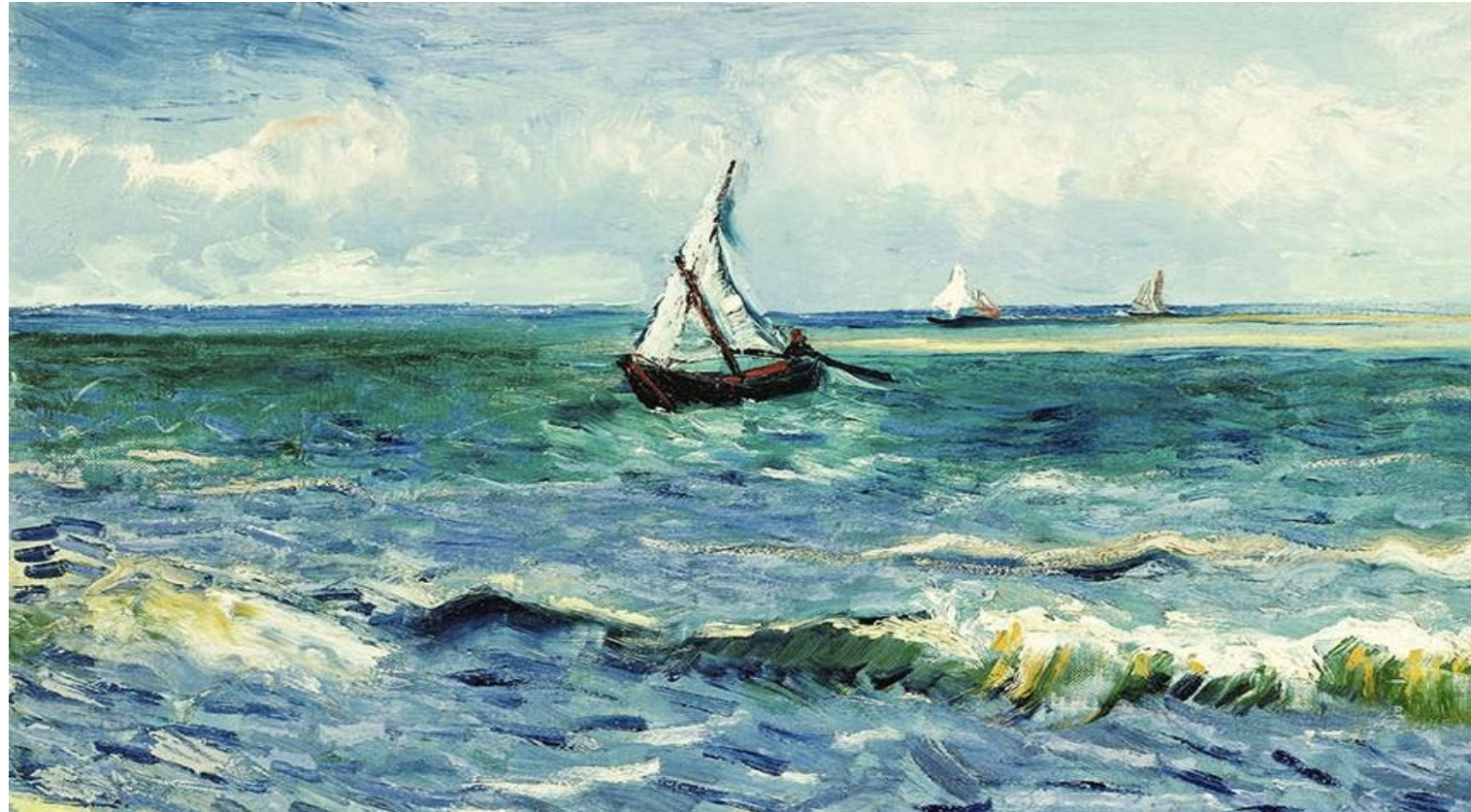



GOS MARINE ENGINEERING INTERNATIONAL LIMITED

REGISTETRED ADDRESS: ROOM 1003, 10/F, TOWER 1, LIPPO CENTER, 89 QUEENSWAY, ADMIRALTY, HONG KONG SAR, CHINA

**OFFICE ADDRESS: RM1302, 13/F, TOWER 2, CHANG FENG MANSION, 14 XINHUO ROAD,
JIANGBEI NEW DISTRICT, NANJING CITY, CHINA**

Tel: +86-25-58279289; Fax: +86-25-58279289;

Mobile: +86 13770664588;+86 18801588099;+86 13705168020

Email: FDR@gosmarine.com.cn; Fortuneforum@163.com; F.yujian@hotmail.com

Website: [Http://www.gosmarine.com.cn](http://www.gosmarine.com.cn)